

# Bulkhead Union

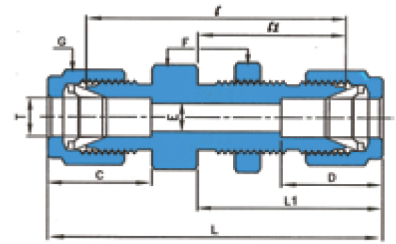

## Fractional Range

Part No.	Tube O.D.	E Min	Width across flat			D	C	I	II	L	L1	Panel	Panel
	T		F	G	Hole							Max	
	inches		Min	inches	Drill Size							Thickness	
1BHU	1/16	1.27	5/16	5/16	8.63	10.92	23.88	13.46	31.50	17.27	5.16	3.05	
2BHU	1/8	2.28	1/2	7/16	12.70	15.24	38.10	24.63	51.30	31.24	8.33	12.70	
3BHU	3/16	3.04	9/16	1/2	13.71	16.00	40.38	25.40	53.59	32.00	9.92	12.70	
4BHU	1/4	4.82	5/8	9/16	15.24	17.78	42.93	26.16	57.65	35.52	11.50	10.16	
5BHU	5/16	6.35	11/16	5/16	16.25	18.54	45.98	28.44	60.70	35.81	13.09	11.17	
6BHU	3/8	7.11	3/4	11/16	16.76	19.30	47.51	29.46	62.23	36.83	14.65	11.17	
8BHU	1/2	10.41	15/16	7/8	22.86	21.84	50.80	31.75	71.12	41.91	19.44	12.70	
10BHU	5/8	12.70	1 1/16	1	24.38	21.84	52.32	32.51	72.64	42.67	22.62	12.70	
12BHU	3/4	15.74	1 3/16	1 1/8	24.38	21.84	58.67	37.33	78.99	47.49	25.79	16.76	
14BHU	7/8	18.28	1 3/8	1 1/4	25.90	21.84	64.26	42.92	84.58	53.08	28.97	19.05	
16BHU	1	22.35	1 5/8	1 1/2	31.24	26.41	71.37	45.21	95.75	57.40	33.73	19.05	

## Metric Range

Part No.	Tube O.D.	E Min	Width across flat			D	C	I	II	L	L1	Panel	Panel
	T		F	F1	G							Hole	Max
	mm		mm	mm	mm							Drill Size	Thickness
3BHU - MM	3	2.4	14	12.7	12	12.9	15.3	38.1	24.6	51.3	31.2	8.3	12.7
4BHU - MM	4	2.4	14	14.3	12	13.7	15.3	40.4	25.4	53.6	32.0	9.9	12.7
6BHU - MM	6	4.8	16	15.9	14	15.3	16.1	42.9	26.2	57.7	33.6	11.5	10.2
8BHU - MM	8	6.4	16	17.5	16	16.2	17.7	46.0	28.6	61.0	36.1	13.1	11.2
10BHU - MM	10	7.9	22	22.0	19	17.2	18.6	48.5	29.4	63.7	37.0	16.2	11.2
12BHU - MM	12	9.5	24	23.8	22	22.8	19.5	50.8	31.8	71.0	41.9	19.5	12.7
15BHU - MM	15	11.9	27	27.0	25	24.4	22.0	52.3	32.5	72.5	42.6	22.8	12.7
16BHU - MM	16	12.7	27	27.0	25	24.4	22.0	52.3	32.5	72.5	42.6	22.8	12.7
18 BHU - MM	18	15.1	30	30.0	30	24.4	22.0	58.7	37.7	78.9	47.4	26.0	16.8
20BHU - MM	20	15.9	35	35.0	32	26.0	22.0	64.3	42.9	84.5	53.0	29.0	17.0
22BHU - MM	22	18.3	35	35.0	32	26.0	22.0	64.3	42.9	84.5	53.0	29.0	19.1
25BHU - MM	25	21.8	41.3	41.3	38	31.3	26.5	71.4	45.2	95.9	57.5	33.7	19.1

Dimensions are for reference only and are subject to change.